

10 ft. Square Aluminum Direct Buried

CPSA1004T1E

CATALOG NUMBER

FINISH

Direct Buried

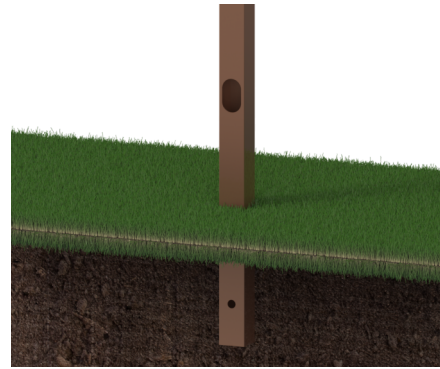

Pole

The pole shaft is a seamless 6063-T6 aluminum alloy extrusion having a uniform wall thickness of 0.250", 0.188", 0.156" or 0.125". Along with CCTV equipment the sides of the shaft may be drilled for mounting luminaire fixtures. All aluminum alloys shall comply with metallurgical and mechanical properties set forth in the Aluminum Association Standards

Hand Hole

An oval reinforced gasketed handhole, having a nominal 3" x 5" inside opening, located 1"-6" above base, is standard on all poles. A grounding provision is located inside the handhole ring

Finish

All exterior metal surfaces are mechanically cleaned to remove all oxides and contaminants prior to coating. The standard finish is a polyester thermosetting powder coating applied to the surface of the substrate to a minimum of 3 mils for all color finishes.

Vibration Damper

If determined necessary an internal, factory installed, Second Mode Vibration Damper will be provided. Customer specification of the damper is available.

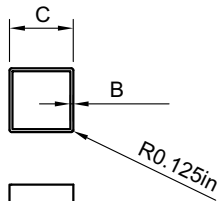

Finish

- 01 = Satin Aluminum
- BA = Black Powder Coat
- BH = White Powder Coat
- BM = Dark Bronze Powder Coat
- BV = Dark Green Powder Coat
- GC = Gray Powder Coat
- ** = Specify Finish

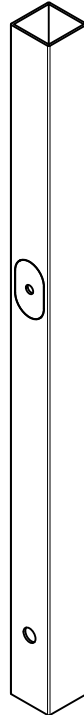
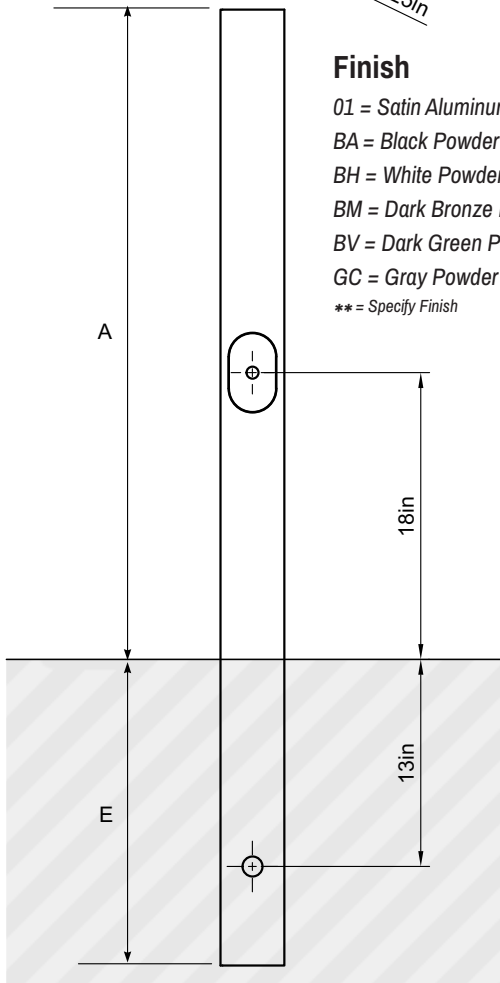

WARNING: Do not install pole without equipment

A Mounting Height	E Embed Section	B Wall Thickness	C Width	Total Weight	EPA 100	Catalog Number
10	3	0.125	4	34	6.0	CPSA1004T1E

